



AquaSense® AV Model

TAG _____

PEMS6000-CON-KIT-IS

Hardwired Automatic Sensor Retrofit Kit For Manual Flush Valve

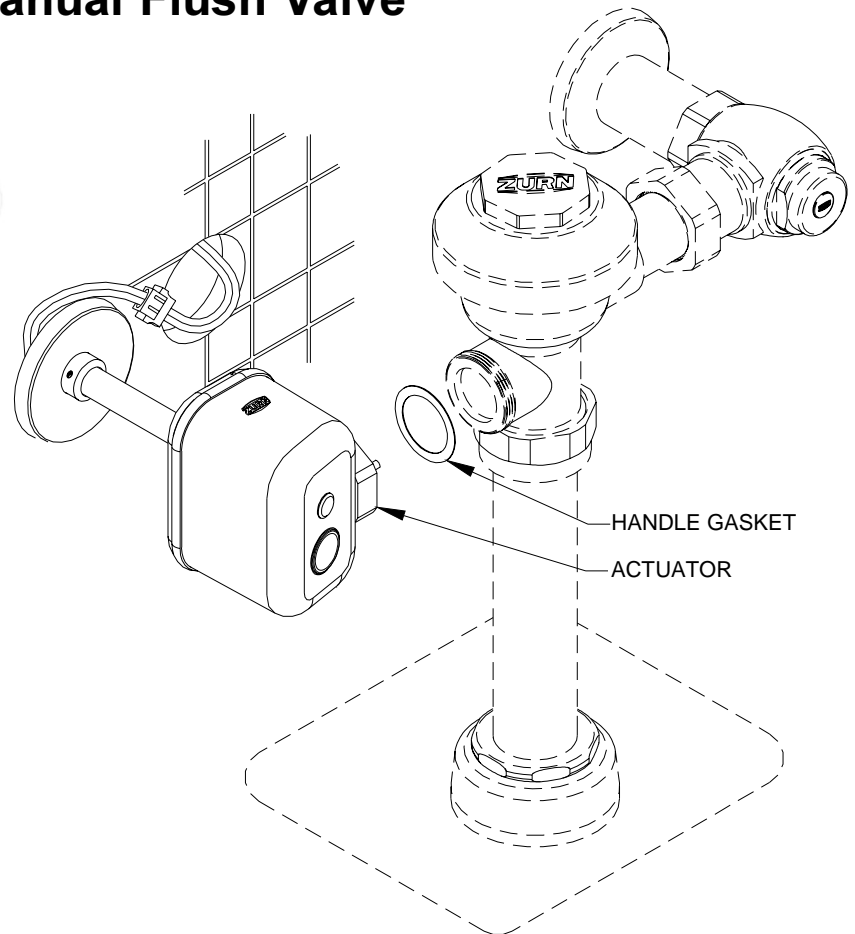

Accessories (Order separate as specified)

PESS6000-BB Battery Back-up (Up to 8 valves)

P6000-PC6 6VDC Plug-in Power Converter
(Up to 8 valves)

P6000-MJ Mini Junction Box

P6000-HW6 Hardwire Power Converter
(Up to 8 valves)

ENGINEERING SPECIFICATION:

ZURN PEMS6000-CON-KIT-IS AquaSense Exposed Hardwired Sensor Retrofit Kit for Flush Valve- The unit incorporates a 6 VDC motorized actuator, an integral infrared convergence-type proximity sensor and a manual push-button override into an all-metal, polished chrome plated housing. Sensor range automatically adjusts to its environment at power up and is powered by a 6 VDC power converter. Kit includes motor actuator, wall escutcheon and power cord. Order power converter separate. Each power converter can accommodate up to eight flush valves.

This space is for Architectural/engineering Approval

ZURN INDUSTRIES, INC. ♦ COMMERCIAL BRASS OPERATION ♦ 5900 ELWIN BUCHANAN DRIVE ♦ SANFORD NC 27330

Phone: 1-800-997-3876 ♦ Fax: 919-775-3541 ♦ World Wide Web: www.zurn.com

In Canada: ZURN INDUSTRIES LIMITED ♦ 3544 Nashua Drive ♦ Mississauga, Ontario L4V1L2 ♦ Phone: 905-405-8272 Fax: 905-405-1292

AquaVantage® is a registered trademark of Zurn Industries, Inc. Rev.
AquaSense® is a registered trademark of Zurn Industries, Inc. Dwg. No. 80946

Date: 9/09/04
Product No. PEMS6000-CON-KIT-IS